



# COURTYARD NEIGHBORHOOD AUSTIN, TX



**The Courtyard is only about 15 minutes from downtown Austin, conveniently located off of Capital of Texas Highway at Courtyard Drive in Northwest Austin.**

The Courtyard is an upscale neighborhood that is both a waterfront and country club community with access along Lake Austin and Bull Creek. The neighborhood consists of about 70 competitively priced homes built between the early 1980s and mid-1990s.

Today, the Courtyard neighborhood is a quiet enclave of homes in a serene natural setting where residents can enjoy lake access and use of the private community park, fishing dock, and walking trails. Many homeowners enjoy stunning views of the cliffs and the lake. Soaring birds and abundant wildlife make the area even more appealing.

The entrance to the Courtyard is just across the highway from the 360 Bridge overlook, one of the city's best sunset viewing spots. Residents enjoy free use of the boat ramp located next to the County Line restaurant on 2222.

The Courtyard community park is a private access recreational area for use by residents and their guests. Located on the banks of Bull Creek, the park features a playscape, picnic tables, barbecue grills, a day dock, walking trails, kayak storage, and restrooms. A network of walking trails winds its way through The Courtyard and connects forested green spaces throughout the community.

Courtyard Tennis and Swim Club - Nestled in the rolling hills of West Austin, Courtyard has served the tennis community for over 50 years. With 14 outdoor courts, 2 indoor courts, and 25-meter heated lap pool lanes, the club is among the finest you can find anywhere.

With beautiful custom home styles, gorgeous lake and city views, active lifestyle amenities, all in a convenient central location, The Courtyard could easily be one of northwest Austin's best-kept secrets.



## **Courtyard Neighborhood Schools**

### **AUSTIN INDEPENDENT SCHOOL DISTRICT**

GRADES PK-12/ENROLLMENT: 81,650

1111 WEST 6TH STREET

AUSTIN, TX 78703. (512) 414-1700

### **HIGHLAND PARK ELEMENTARY SCHOOL**

GRADES PK-5/ENROLLMENT: 641

4900 FAIRVIEW DRIVE

AUSTIN, TX 78731. (512) 414-2090

### **LAMAR MIDDLE SCHOOL**

GRADES 6-8/ENROLLMENT: 1,130

6201 WYNONA AVENUE

AUSTIN, TX 78757. (512) 414-3217

### **MCCALLUM HIGH SCHOOL**

GRADES 9-12/ENROLLMENT: 1,761

5600 SUNSHINE DRIVE

AUSTIN, TX 78756. (512) 414-2519

# COURTYARD SUBDIVISION

- Subdivision Boundary
- Courtyard Subdivision Parcel Boundary
- Parcel Boundary
- HOA Common Areas

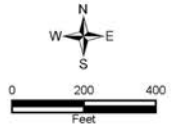

Data Source: City of Austin  
Subdivision boundary confirmed with  
Travis Central Appraisal District.

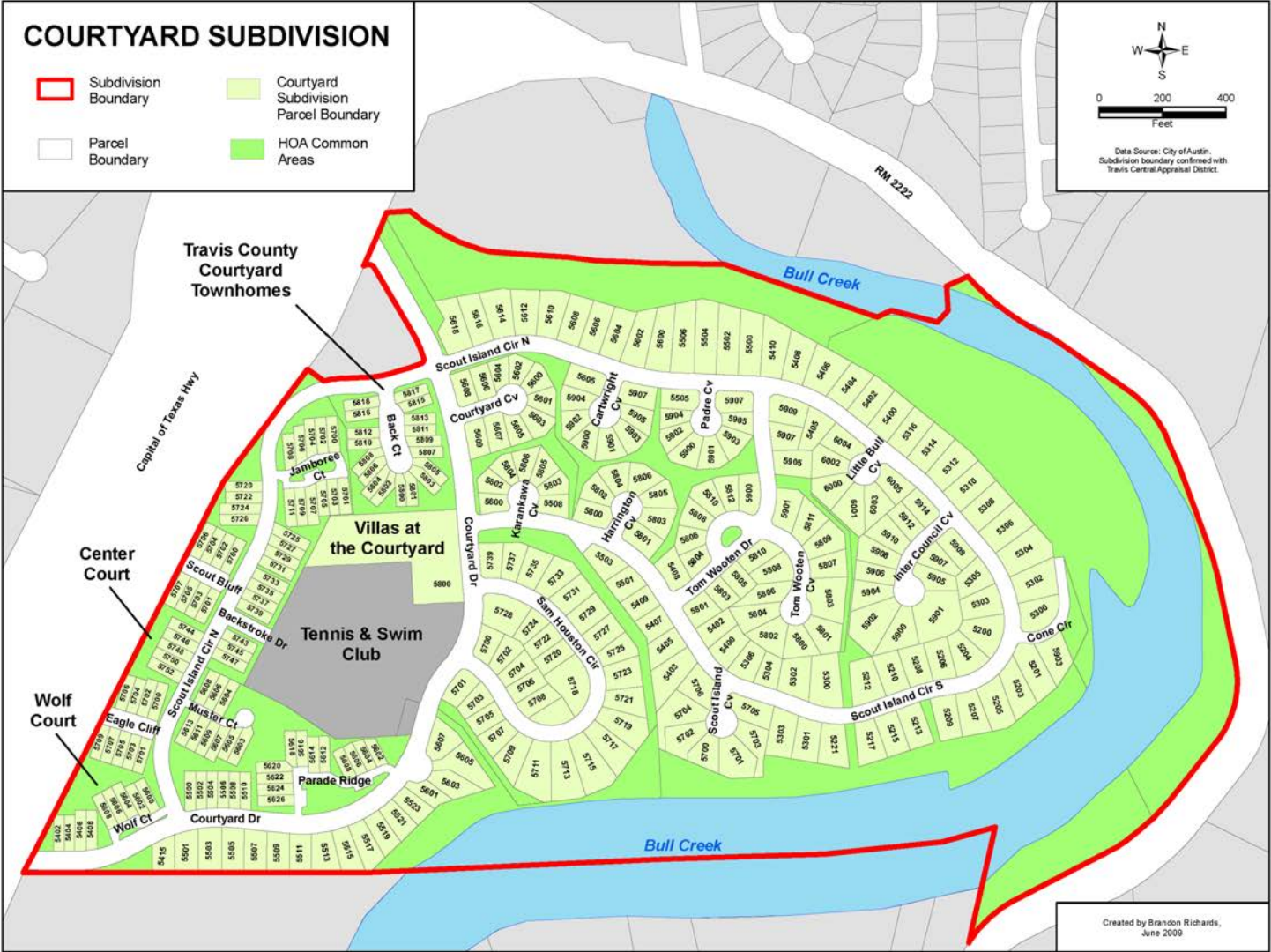

Created by Brandon Richards,  
June 2009